



base<sup>+</sup>



# The intelligent garage door operator

Expandable with a wide range of additional equipment

# ACCESSORIES

Track extensions



## Track extension set

Length 1096 mm, incl. ceiling bracket, long isolator chain (including magnet)

#10460V000



## Ceiling mounting unit set

for track MS 1,25 mm; incl. fixing material

#1646V000

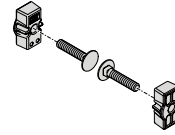

## Ceiling suspension insert

for angle profile use (width 18 mm) for fastening on the ceiling

#S10178-00001

Door brackets

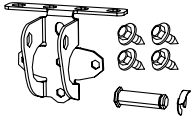

## Door bracket set

incl. screws and bolts one piece bracket

#1650V000

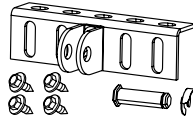

## Door bracket set

incl. screws and bolts complete bracket

#S10201-00001

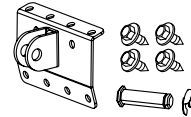

## Door bracket set

incl. screws and bolts type H

#S10228-00001

Brackets

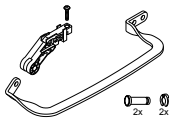

## Low headroom fitting

incl. pluggable adapter "back"

#7044V000



## Door bracket

direct mounting track to ceiling incl. screws and bolts complete bracket

#7045V000

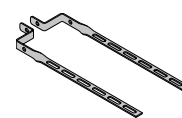

## Bracket for door frames

Ceiling suspension connection cross beam

#S10355-00001

## SERVICE INTERFACE

### SOMlink #7040V000

With intelligent control technology (for dealers), there are additional options for easily adjusting features and parameters with a web app using your smartphone or tablet.



## TRANSMITTER



### Pearl Vibe #4019V000

- 4-command transmitter
- Bi-directional radio system, frequency: 868.95 MHz
- Efficient vibration motor for long battery life
- Reliable radio control system with good range (approx. 60 – 150 m)\*
- Sensible vibrating feedback
- 128 bit AES rolling code encryption
- Collision-resistant

### Matching accessories:

Holder for installing the hand-held transmitter in a car or on the wall can be delivered – just stick it on and screw it in.

#4643V000

Holding clip for installing the hand-held transmitter on the sun visor in a vehicle.

#S10092-00001

\* environment-dependent

# THE NEXT GENERATION OF OUR GARAGE DOOR OPERATORS

## QUALITY

- Universal drive for sectional doors, overhead doors, swing doors, canopy doors\*, side hinged doors\*, side-sectional doors and sliding doors
- Saves power: <1 watt standby
- Made in Germany
- Integrated LED technology: durable, energy-saving and efficient lighting

## SAFETY

- Motor with high automatic locking and active counter-pressure at all points in the event of an attempted break-in
- Connection option for battery pack for emergency operation in the event of a power failure
- Locking magnet for motor, locks in any position, even during ventilation function/partial opening (**Lock # 1651V000** available as an option)
- Thanks to the integrated emergency release, the carriage can be engaged and disengaged in any position
- Bi-directional, secure **SOMloq2** radio system

\* Special fitting required

### Track

- The track unit (standard equipment) opens sectional doors up to a height of 2,500 mm, swing doors up to a height of 2,750 mm
- By extending the track, even taller doors can be opened (extension set # 10460V000)

### Carriage

- Certified restriction of closing forces acc. to EN 12445 by electronic motor monitoring (lft Rosenheim-certified)

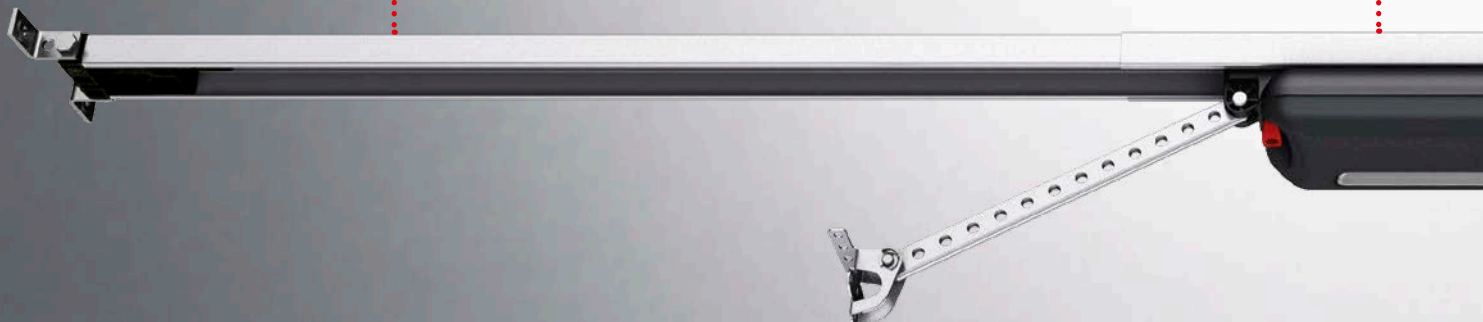

MADE IN GERMANY





## VERSATILITY

- Countless accessories for extension, e.g. **Memo** hand-held transmitter memory, **Senso** humidity sensor, **Lock** locking magnet, **Lumi+** additional LED lighting and much more...
- Additional connection options without spiral cable directly on carriage (safety contact for the slip door or safety edge OSE or 8k2)
- Removable carriage without track disassembly
- Easy shortening or lengthening of the track possible (extension set # 10460V000)

## INTELLIGENCE

- Automatic learning process: self-learning force curve with continual adjustment e.g. summer-/winter operation
- Optimal speed profiles for quick opening and secure closing
- Operation compliant with standards
- Automatic calibration of door operation through direct entry of measured operating forces
- Pre-selectable door types via DIP switch
- Active braking for moving doors
- Countless setting and querying options via **SOMlink**
- Gear-saving soft start/stop
- Automatic end position detection in Door CLOSE when programming, the closing pressure can also be individually adapted to the structural conditions

### Chain

- High-quality fixed chain (galvanic nickel-plated)
- Wear- and maintenance-free, pre-tensioned via springs with high tensile strength

### Roof control connection option

- Pulse button
- Warning light 24 V/DC, max. 25 watt
- 2- or 4-wire light barrier
- Additional socket light (Lumi+)
- Additional socket relay
- Socket battery pack

### Ceiling mounting unit

- Flexible and versatile

**Set S 9060 base+** #8700V000 **Set S 9110 base+** #8500V000

**Set S 9080 base+** #8800V000

3-piece track including carriage, roof control, fixing material (bracket, attachment to header and ceiling mounting unit), push arm and door bracket, pre-programmed Pearl Vibe 4-command transmitter (#4019V000)

# ADDITIONAL EQUIPMENT

Create your own optional value-added product



Discover the  
new base+ at  
[www.sommer-base.eu](http://www.sommer-base.eu)

All accessories are easy to install via Plug and Play.  
Sockets are colour-coded and labelled.



## 1 Lock #1651V000

Locking magnet which mechanically blocks the motor in any position up to an attack force of 300 kg (certified), thereby improving the existing break-in protection. (mechanical locking mechanism of the operator)



## 2 Senso #10371

For recording air humidity and temperature in the garage. The carriage automatically opens and closes the door a bit if necessary, ensuring perfect air circulation. This reduces the risk of mould formation.



## 3 Memo #10373

Used to expand the memory to 450 transmitter commands. If service is required, the saved transmitters can be easily moved to a new carriage.



## Buzzer #7043V000

Three functions in one product: The alarm buzzer recognises a break-in attempt and outputs a loud signal tone. The warning buzzer, on the other hand, outputs an acoustic signal during the closing process or optionally when the slip door is open.



## Lumi+ #7041V000

Additional LED lighting for the roof control. It is switched in parallel with the lighting in the carriages and can be easily switched on and off using the light function by means of a hand-held sensor.



## Laser #10378

Gives optical assistance for perfectly positioning a vehicle in the garage. The laser is active during the opening process and the set light burning time.

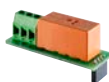

## Relay #7042V000

Additional relay for additional switching of a garage or courtyard light.



## Motion #S10343-00001

Uses a passive infrared sensor to detect the invisible thermal radiation of moving bodies (humans/animals, etc.) and reacts to them. The operator lighting (additional lighting/relay) switches on automatically for safe movement when the garage is entered.



## Accu #S10523-00001

Assumes the power supply of the operator for > 5 door cycles in the event of a power failure.

# BI-DIRECTIONAL RADIO SYSTEM SOMloq2



Guarantees reliable remote control with good range and direct feedback for increased safety and convenience.

Our new products, equipped with the bi-directional SOMloq2 radio system, transmits radio signals in both directions when the corresponding transmitter is used, e.g. Pearl Vibe feedback vibration.

## The system also offers:

- Feedback of whether the sent command is being processed by the receiver
- The option of querying door positions/reception status
- Improved range and higher reliability due to the hop function, since the signal is actively forwarded by SOMloq2 receivers
- Maximum protection from hackers with 128 bit AES encryption with Rollingcode
- Auto-repeat function for comfortable opening while approaching the object
- Downward compatible with the Somloq Rollingcode radio system, making it possible to control existing operators and radio receivers

## TECHNICAL DATA

Operator	S 9060 base <sup>+</sup>	S 9080 base <sup>+</sup>	S 9110 base <sup>+</sup>
Max. pulling/pressure force	600 N	800 N	1.100 N
Max. door width/door height <sup>1)</sup>			
Sectional door	4.500 mm/2.500 mm	6.000 mm/2.500 mm	8.000 mm/2.500 mm
Retractable door	4.500 mm/2.750 mm	6.000 mm/2.750 mm	8.000 mm/2.750 mm
Canopy door	4.500 mm/2.050 mm	6.000 mm/2.050 mm	8.000 mm/2.050 mm
side-opening sectional-/Sectional-horizontal door <sup>2)</sup>	2.500 mm (4.500 mm)/2.500 mm	2.500 mm (5.750 mm)/2.750 mm	2.500 mm (6.850 mm)/3.000 mm
Travel length (standard)	2.750 mm	2.750 mm	2.750 mm
Max. travel length extended	4.900 mm 2 x extensions (1.096 mm)	6.000 mm 3 x extensions (1.096 mm)	7.100 mm 4 x extensions (1.096 mm)
Max. door weight	120 kg	160 kg	200 kg
Max. running speed <sup>3)</sup>	240 mm/s	210 mm/s	180 mm/s
Power consumption (power-saving mode)	< 1 W	< 1 W	< 1 W
Switch-on duration after S3 in %	40%	40%	40%
Number of radio memory positions	40	40	40

1) The values can deviate depending on the installation position

2) Side-sectional doors and roller doors wider than 2,500 mm can be built with a corresponding number of extensions

4) Measured without door



**SOMMER ANTRIEBS- UND FUNKTECHNIK GMBH**  
 HANS-BÖCKLER-STR. 21-27 | D-73230 KIRCHHEIM/TECK  
 PHONE +49 (0)7021/8001-0 | FAX +49 (0)7021/8001-100  
 INFO@SOMMER.EU | WWW.SOMMER.EU

